

WP1842LC INSTRUCTIONS

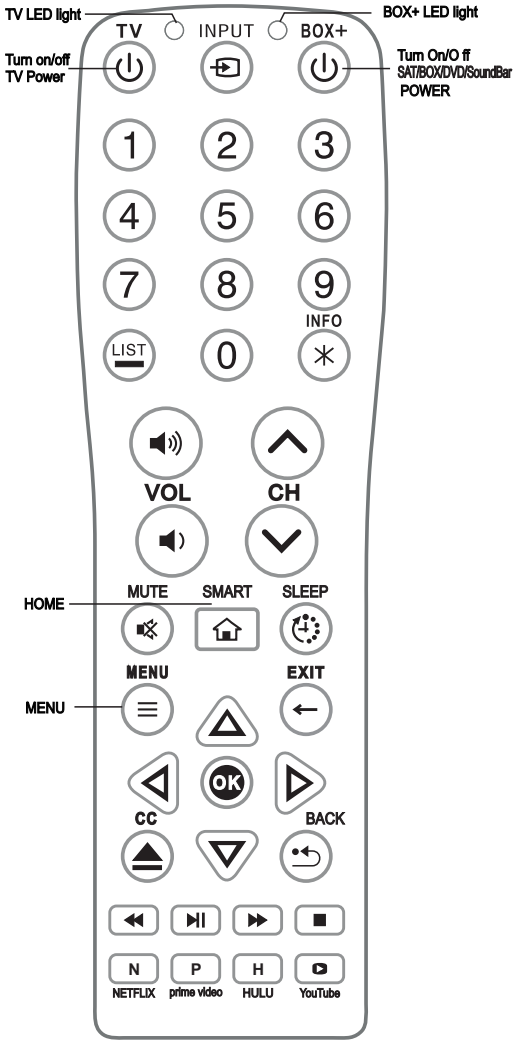

Battery:2XAAA batteries.  
(Not included)

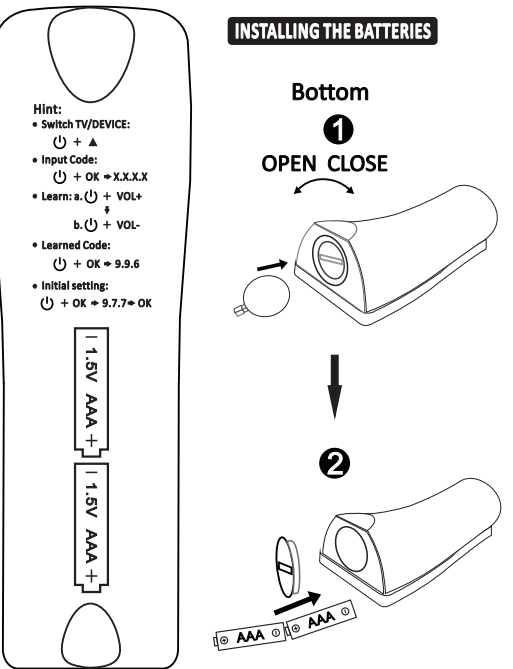

SM.0001938E000

1. Initial State:

- 1). In the initial state of the TV device, you can directly control LG, SONY, SAMSUNG, PHILIPS, TOSHIBA, PANASONIC TVs.
- 2). In the initial state of other devices, you can directly control Roku Box and APPLE Box.

2. Switch Device:

[TV POWER] + [▲], [BOX+ POWER] + [▲]

- 1). Press [TV POWER] and [▲] keys together for 1 second, the TV operation indicator flashes 3 times, and the TV can be operated.



- 2). Press [BOX+ POWER] and [▲] keys together for 1 second, the BOX+ operation indicator flashes 3 times, and it switches to BOX+ mode, retaining the [TV's POWER] and [INPUT] functions.

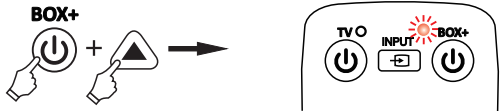

3. Manually Entering Codes:

Step 1 is for TV and step 2 is for other BOX+

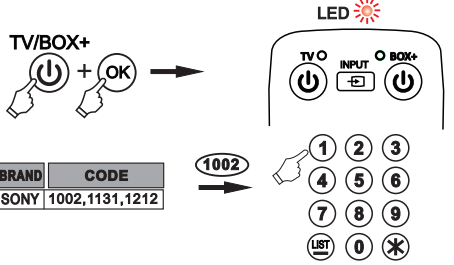

- 1). Simultaneously press the [TV POWER] and [OK] buttons for 3 seconds until the indicator light next to the [TV POWER] button stays on. Enter the four-digit code corresponding to the brand of the device from the code list. The indicator light will turn off. If an invalid code is entered, the indicator light will flash four times and automatically exit.
- 2). Simultaneously press the [BOX+ POWER] and [OK] buttons for 3 seconds until the indicator light next to the [BOX+ POWER] button stays on. Enter the four-digit code corresponding to the brand of the device from the code list. The indicator light will turn off. If an invalid code is entered, the indicator light will flash four times and automatically exit.

★ **Note: If an incorrect code is entered, the device may not be controllable or some functions may be non-operational. Please re-enter other codes for the device brand until a complete match is found.**

4. Quick Search:

Press and hold [TV POWER] or [BOX+ POWER] + [CH▲] for 5 seconds → CH▲/CH▼ → OK)

1). Single Search:

Point the remote control at the device (within 2 meters). Simultaneously press and hold the [POWER] and [CH▲] for the corresponding device for 3 seconds. When the light turns on, release the buttons. Now, press [CH▲] once to search forward step by step, or press [CH▼] once to search backward step by step. When the device responds or turns off, stop immediately and press other buttons to confirm whether the device can be operated. If it can be operated, press OK to save and exit. If not, continue searching using the above method until the correct code is found.

2). Automatic Quick Search:

Point the remote control at the device (within 2 meters). Simultaneously press and hold the [TV POWER] or [BOX+ POWER] and [CH▲] buttons. When the LED light stays on, release the buttons. Then, press and hold [CH▲] or [CH▼] until the device responds or turns off, and then release the button immediately. Press any other buttons to confirm whether the device can be operated. If it can be operated, press OK to save. If not, you can use the single step search method to find the correct code, usually by pressing [CH▼] to search backward.

5. SLEEP Function:

- 1). This function is only valid in TV mode. Press the [SLEEP] key, and if the TV has a timer function, follow the on-screen instructions.



- 2). For Tv's without a timer function:

- a. Press the [SLEEP] key for 3 seconds, the LED light will stay on. Enter a two-digit number (01–99) in minutes, the LED light will turn off, and the setting is complete.

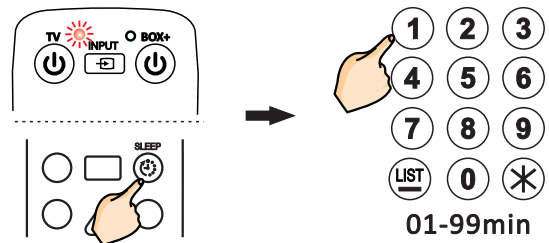

- b. Aim the remote with the timer function set at the TV screen. When the time is up, the power-off signal will be sent, turning off the TV. To exit midway, press [TV POWER] or [SLEEP] key to terminate the timer and exit.



6. Code Recognition:

[POWER+OK] →9 9 0→1/2/3/4)

- 1). Press [POWER] and [OK] keys together for 3 seconds, release when the LED light stays on.
- 2). Enter 990, the light flashes twice and then turns off, entering code recognition mode.

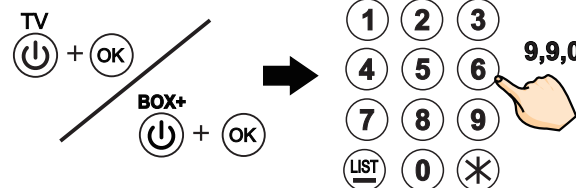

- 3). Press 1/2/3/4 keys in sequence, waiting for the LED light to flash after each press. The number of flashes indicates the corresponding value for that digit. If the light doesn't flash, the value is 0. For example, pressing 1 flashes once, pressing 2 doesn't flash, pressing 3 flashes twice, pressing 4 flashes five times; thus, the current code is 1025, which can be found in the code list as the second set of codes for HITACHI TV.

7. Learning Function:

The Original remote is A, and the remote need to learn is B.

- 1). Press B remote's [POWER] key and [VOL+] together to make B remote's LED light stay on, it will enter the learning mode.

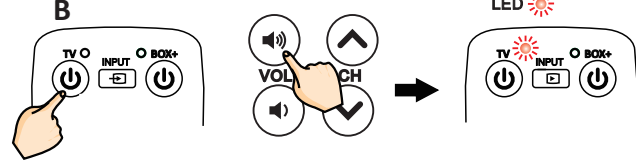

- 2). Align A and B remote's head-to-head within 1-3CM. Start to learn the buttons one by one.



- 3). Press a button on remote A to enter transmission mode, and slowly move remote A forward, backward, left, and right until the LED on remote B flashes. This position is optimal for learning. Keep the remotes in this position without moving them during the learning process.

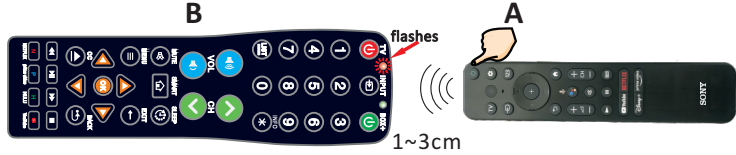

- 4). Press the function key on A remote(e.g., power key), and B remote's LED will flash. Press B remote's power key to make the LED stay on.
- 5). Repeat the above steps to learn all or part of A remote's functions onto B remote.
- 6). When B remote's LED is on, press B remote's [POWER] key and [VOL-] key together to save and exit, the LED will turn off, and the learning is complete.

- 7).If some buttons don't work after learning, follow the same steps to re-learn the non-working buttons until all necessary functions are successfully learned.

8. Copy Function:

Must be the same type of remote, A remote is the fully learned one, B remote needs to copy

- 1). Set A remote to signal transmitting mode by pressing [MUTE] and digit 1 keys together. When the LED light stays on, release the keys and place A remote on a flat surface.
- 2). Set B remote to signal receiving mode by pressing [MUTE] and digit 3 keys together. When the LED light stays on, release the keys.



- 3). Align B remote's receiving light 1- 3CM from A remote's transmitting light, move slowly until both remote's LED lights start flashing. When B remote's LED flashes slowly then turns off, and A remote's LED flashes slowly and then stays on, the copying is complete. A remote is now ready to copy to another B remote. To stop copying, press [MUTE] and [VOL-] keys together to exit [COPY] mode.

9. Volume Sequence Code Function:

[VOL+] and [OK] press together for 3 seconds

- Press [VOL+] and [OK] keys together for 3 seconds to make the device indicator flash once. Now [VOL+], [VOL-], and [MUTE]will work on the flashing indicator device. Each press switches the control to the next device.

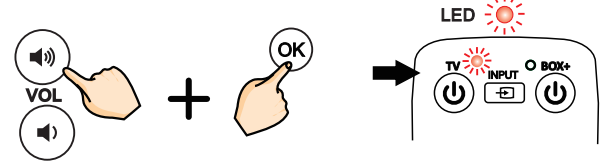

10. Restore Factory Settings:

[POWER]+[OK] 3 seconds →9 7 7

- Press [POWER] and [OK] keys together for 3 seconds until the LED light stays on, enter 977, and press [OK]. The LED light will flash 4 times and then turn off, restoring the current device to factory settings.

11. Restore Previous Learning State:

[POWER]+[OK] 3 seconds →9 9 6

- Press [POWER] and [OK] keys together for 3 seconds until the LED light stays on, enter 996. The LED light will flash 4 times and then turn off, restoring the current device to the Previous Learning State.

SPECIFICATIONS

- Shell material: ABS
- Operable distance: More than 8 metres
- Power requirements: DC 3V
- Battery type: Two size AAA batteries

SERVICE

If you have troubles in using the remote control so please contact us. We will try our best to serve you. Please don't open the Controller by yourself. We will not take the responsibility if you open it by yourself.

NOTE ON BATTERIES

- ! Do not mix old batteries with ones or mix different types of batteries together.
- ! If the electrolyte leaks inside the battery compartment, clean it with a piece of cloth and replace the old batteries with new ones.
- ! To prevent the electrolyte from leaking, remove the batteries when you plan not to use the controller for along period of time.